

The definitive tool for plumbing work, 19.0mm[3/4"]-Drive

**ASAHI**  
TOOLS

# CROWFOOT WRENCH

*The long-awaited crowfoot wrench with a 19.0mm[3/4"]-Drive is now available!*



## Point 1

Suitable for work in narrow spaces such as piping!

It is possible to work in narrow places where wrenches and spanners cannot be used, such as around various pipes of automobiles and machines!

For automobile piping, etc.

Automobiles Trucks & buses

Construction machinery Heavy machinery

- Air conditioner
- Around power steering
- Hydraulic piping for brakes
- Around various sensors

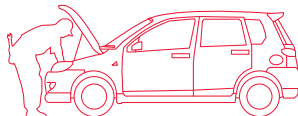

Various types of piping for machinery

- Maintenance of hydraulic piping
- Other various piping

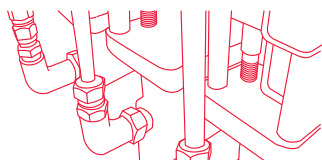

## Point 2

Extensive line-up!!

Large sizes available!!

7 sizes available from 30 to 55 mm (Width across flat)!!

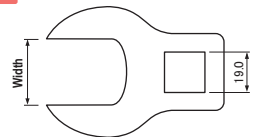

30 mm 32 mm 36 mm 41 mm 46 mm 50 mm 55 mm

### How to use

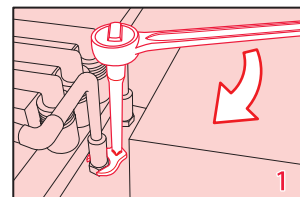

Attach crowfoot wrench to nut and tighten with ratchet.

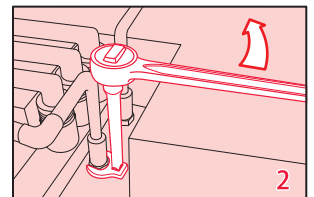

Back using the ratchet mechanism

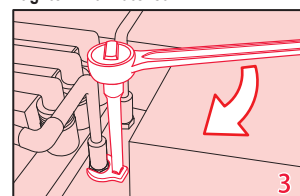

Tighten again

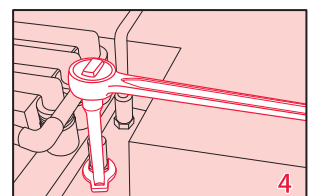

Repeat steps 1-3.



### VC6 Crowfoot wrench specifications

Code	mm	B mm	b mm	H mm	L mm	effective length ℓ mm	Weight g
VC6030	30	55	36	19	89	55	380
VC6032	32	60	36	19	90	55	410
VC6036	36	66	38	19	93	55	450
VC6041	41	74	38	19	106	65	560
VC6046	46	82	42	19	110	65	650
VC6050	50	90	42	19	113	65	720
VC6055	55	96	45	19	117	65	780

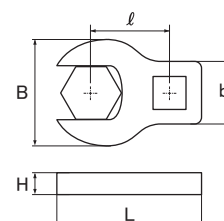

### □ Also available in 12.7mm[1/2"]-Drive and 9.5mm[3/8"]-Drive

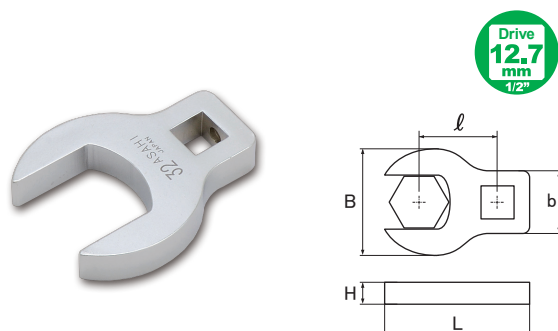

Code	mm	B mm	b mm	H mm	L mm	effective length ℓ mm	Weight g
VC4017	17	32	22	12	55	33	80
VC4019	19	36	22	12	57	35	90
VC4022	22	42	24	12	61	38	113
VC4024	24	46	26	12	64	38	128
VC4027	27	50	27	12	67.5	40	145
VC4030	30	54	28	12	73	43	164
VC4032	32	56	28	12	73	43	165
VC4036	36	62	30	12	77	45.5	191
VC4041	41	68	32	12	86	50	224
VC4046	46	74	32	12	91	52	254
VC4050	50	79	34	12	94	54	274
VC4055	55	84	34	12	101.5	57	314
VC4060	60	89	34	12	103.5	59	320

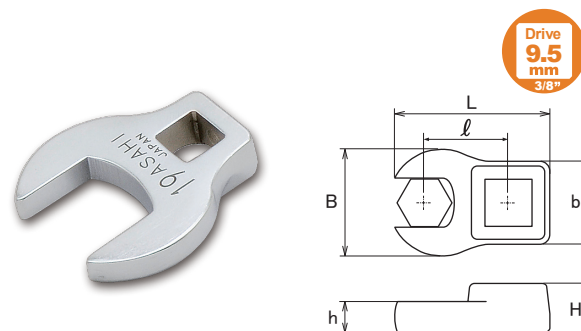

Code	mm	B mm	b mm	H mm	h mm	L mm	effective length ℓ mm	Weight g
VC3008	8	21	17	10	6.3	31.6	15.6	21
VC3009	9	21	17	10	6.3	31.4	16.2	20
VC3010	10	21	17	10	6.3	31.2	16.8	20
VC3012	12	24	17	10	6.3	33.7	17.9	25
VC3013	13	24	17	10	6.3	32.7	18.5	25
VC3014	14	24	17	10	6.3	32.6	19.1	25
VC3015	15	28.8	17	10	6.3	37.5	20.2	30
VC3016	16	28.8	17	10	6.3	37.4	20.7	29
VC3017	17	28.8	17	10	6.3	37.4	21.3	27
VC3019	19	38	19	10	6.3	42.6	24	42
VC3021	21	38	19	10	6.3	41.6	25.1	40
VC3022	22	41	19	10	6.3	46	25.7	48
VC3024	24	41	19	10	6.3	44	26.8	45
VC3026	26	46	19	11.5	9.5	50	28	80
VC3027	27	46	19	11.5	9.5	50	28.6	70
VC3029	29	50	19	11.5	9.5	51	29.7	75
VC3030	30	50	19	11.5	9.5	51	30.3	75
VC3032	32	50	19	11.5	9.5	50	31.5	72

Made In Japan

**ASAHI TOOLS** Asahi Metal Industry Co.,Ltd.

Export dept.

9F, Toua Bldg., 4-5-7, Minamihommachi, Chuo-ku Osaka-shi, Osaka, 541-0054, Japan

Mail : export@asahi-tool.co.jp

