

T Type Quick-Turn Hexagon Key Wrench

Separate type

All 5 sizes



Detachable handle for compact storage

Since the handle can be stored in the body, it is convenient for carrying and portable work without taking up storage like existing T-type Hexagon key wrenches.

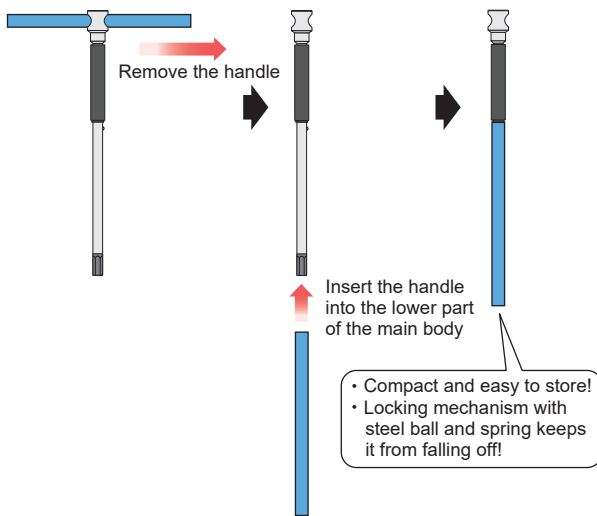

Quick-turn function

The quick-turn collar enables speedy work.

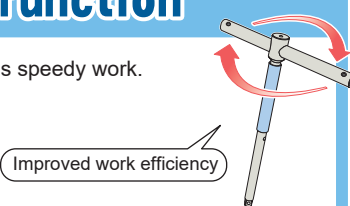

Can be used with either T-shape or L-shape

The handle slides, so work can be performed with either the T-shape or L-shape depending on the work situation.

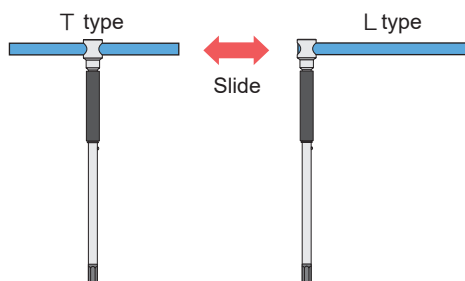

VTH T Type Quick-Turn Hexagon Key Wrench Separate Type



Code	Two-face width mm	L1 mm	D1 mm	L2 mm	D2 mm	L3 mm	Weight g
VTH0300	3	125	9	120	6.4	210	35
VTH0400	4	180	11	120	8.4	220	69
VTH0500	5	180	11	120	8.4	220	70
VTH0600	6	210	16	140	10.4	245	135
VTH0800	8	250	19	175	11.6	280	200

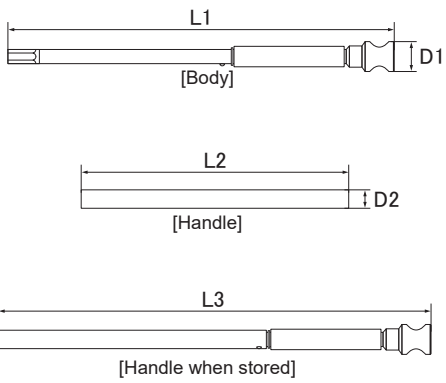

Can be stored neatly without taking up much space



Since it is not bulky like existing T-type Hexagon Key Wrenches, it takes up less space when stored in a tool box or hung on a hook, allowing for smooth removal.

Made In Japan

ASAHI TOOLS Asahi Metal Industry Co.,Ltd.

Export dept.
9F, Toua Bldg., 4-5-7, Minamihommachi, Chuo-ku Osaka-shi, Osaka, 541-0054, Japan
Mail : export@asahi-tool.co.jp

